

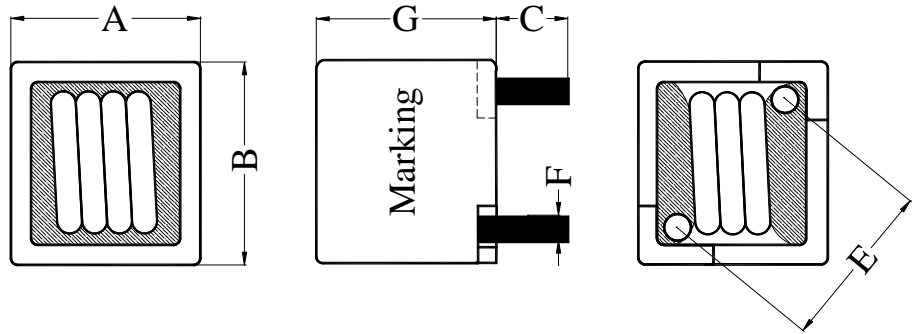

POWER CHOKE

External Dimensions

(Unit:mm)



Series P/N	A(Max.)	B(Max.)	C	E	F	G(Max.)
LRC5343H-R47LU	13.5	12.5	3.5±0.5	10.5±0.5	1.7±0.1	11.0
LRC5343H-R60LU	13.5	12.5	3.5±0.5	10.5±0.5	1.7±0.1	11.0
LRC5343H-R80LU	13.5	12.5	3.5±0.5	10.5±0.5	1.7±0.1	11.0
LRC5343H-1R0LU	13.5	12.5	3.5±0.5	10.5±0.5	1.3±0.1	11.0
LRC5343H-1R8LU	13.5	12.5	3.5±0.5	10.5±0.5	1.3±0.1	11.0
LRC5343H-3R3MU	13.5	12.5	3.5±0.5	11.0±0.5	1.0±0.1	11.0
LRC5343H-4R7MU	13.5	12.5	3.5±0.5	11.0±0.5	0.8±0.1	11.0

Feature

1. Very low DC resistance;
2. With large current loads;
3. Compact size,high performance,low cost.

Application

1. Desktop computers;
2. Servers,workstations;
3. VGA card;
4. High-End switches and routers;
5. Voltage-regulator modules.



POWER CHOKE

Product Identification

LRC 5343 H - 1R0 L U
1 2 3 4 5 6

- | | |
|---------------------|-------------------------|
| 1. Series Name Code | LRC Series |
| 2. Dimensions Code | See above table |
| 3. Inductance Code | 1R0:1.0uH |
| 4. Shape Code | H:Horizontal,V:Vertical |
| 5. Tolerance Code | L:+/-15%,M:+/-20% |
| 6. Special Code | U:RoHS part |

Electrical Characteristic

Series P/N	Inductance (uH)	Test Frequency (KHz)	DC Resistance (mΩ)	Isat (A)	Irms (A)
LRC5343H-R47LU	0.47±15%	100	0.70±10%	55	32
LRC5343H-R60LU	0.60±15%	100	0.70±10%	50	30
LRC5343H-R80LU	0.80±15%	100	0.70±10%	42	26
LRC5343H-1R0LU	1.0±15%	100	1.5±10%	34	22
LRC5343H-1R8LU	1.8±15%	100	1.8±10%	26	17
LRC5343H-3R3MU	3.3±20%	100	5.0Max.	20	12
LRC5343H-4R7MU	4.7±20%	100	8.6Max.	17	10

Note:

1. Test condition:100KHz,1.0Vrms;
2. Isat:This DC current indicates that the inductance drops 15%(typ.) from its initial value;
3. Irms:This DC current indicates that the surface temperature rise 40°C (typ.) from 25°C ambient;
4. Test Equipments: WK3260A meter for L;WK3260A and WK3265B meter for Isat & Irms;GAIN KAI TA 502BC meter for DCR;
5. Operation temperature:-40°C to 125°C.